

Copyright is reserved  
Copying or reproduction of this drawing or electronic data without the written permission of the legal owner is prohibited

**Disclaimer**  
No responsibility is implied for the accuracy or for any consequence resulting from the mis use or alteration of this information

**Explanations**  
Unless otherwise stated:  
• General tolerances are to ISO 2768-mK  
• Dimensions are in millimetres  
• Symbols should be read in conjunction with BS 8541-2

**Instructions**  
Responsibility is not accepted for values obtained in scaling from this drawing  
Construction information should be taken from written dimensions only  
Inconsistencies should be reported to the legal owner immediately

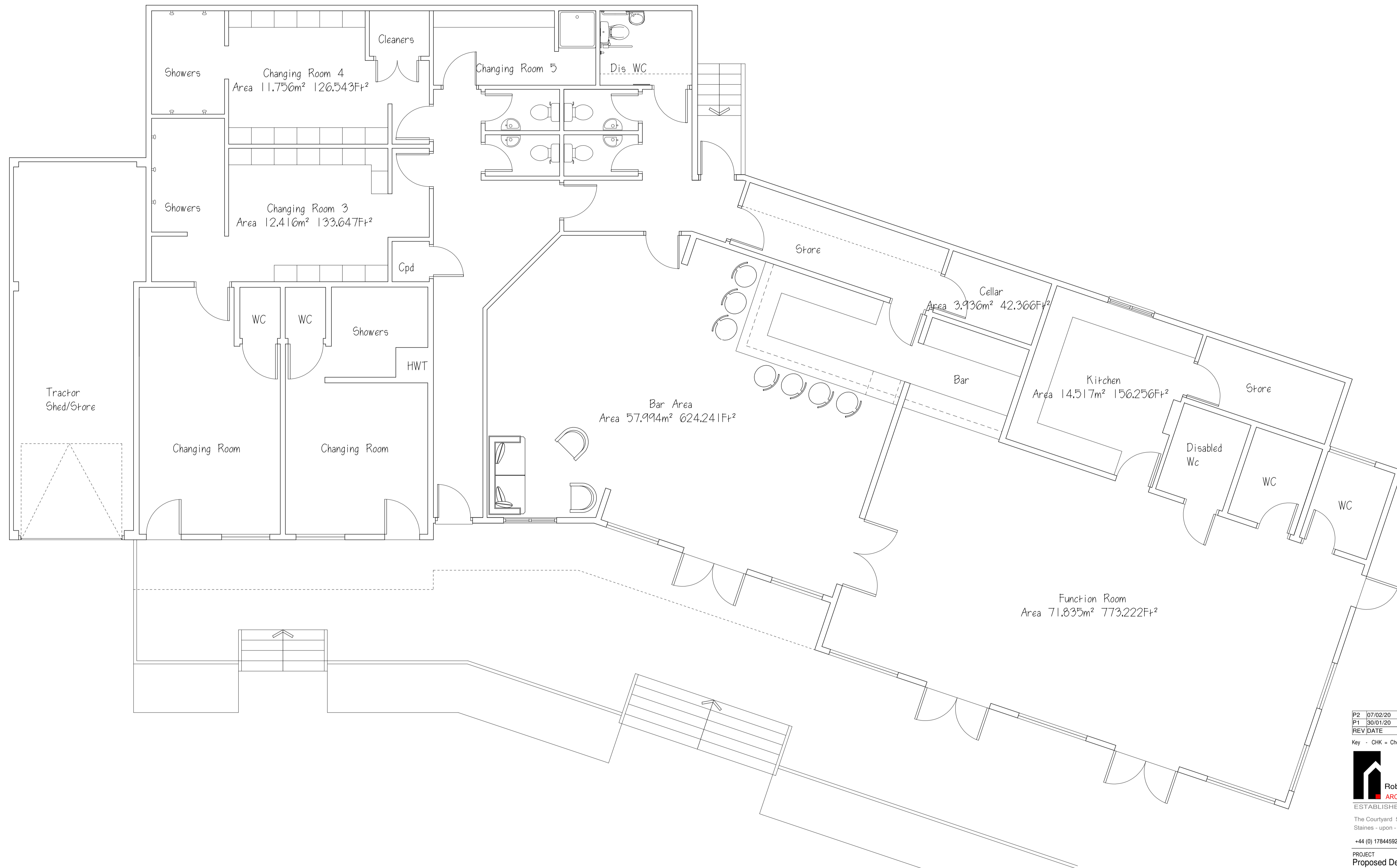

P2	07/02/20	Amended To Client's Comments	RN - GS
P1	30/01/20	For Client Comment	RN - RN
REV	DATE	COMMENT	CHK - APD

Key - CHK = Checked by APD = Approved by

**Robert Davies John West Ltd**  
ARCHITECTS  
ESTABLISHED 1973  
The Courtyard 59 Church Street  
Staines - upon - Thames TW18 4XS  
+44 (0) 1784459211 | info@rdjwld.com | www.rdjwld.com

PROJECT  
Proposed Development,  
Shepperton Cricket Club,  
Russell Road, Shepperton

TITLE  
Proposed Ground Floor Plan

PURPOSE OF ISSUE	DRAWN BY	CHECKED BY
Preliminary	RN	RN
PROJECT No	STATUS	REVISION
L1467	S3	P2
SCALE @ A1		1:50

DRAWING NUMBER  
**1467-RDJWL-01-00-DR-A-0020**