



General notes

All setting out must be checked on site
All levels must be checked on site and refer to Ordinance Datum Newlyn unless alternative Datum given
All fixings and weatherings must be checked on site
All dimensions must be checked on site
This drawing must not be scaled
This drawing must be read in conjunction with all other relevant drawings , specification clauses and current design risk register
This drawing must not be used for land transfer purposes
Calculated areas in accordance with Assael Architecture's Definition of Areas for Schedule of Areas
This drawing must not be used on site unless issued for construction
Subject to survey, consultation and approval from all statutory Authorities

Drawing revision prefix (not applied to sketches):
P=Preliminary
C=Contract

© 2020 Assael Architecture Limited

Assael Architecture Limited has prepared this document in accordance with the instructions of the Client under the agreed Terms of Appointment. This document is for the sole and specific use of the Client and Assael Architecture shall not be responsible for any use of its contents for any purpose other than that for which it was prepared and provided. Should the Client require to pass electronic copies of the document to other parties, this should be for co-ordination purposes only, the whole of the file should be so copied, but no professional liability or warranty shall be extended to other parties by Assael Architecture in this connection without the explicit written agreement thereto by Assael Architecture Limited.
Drawing notes

Electronic file reference

AA A3445 200 Plans

Status R:	Revision	Date	DRN	CHK
	4	PLANNING	24/09/2020	JL MR

Purpose of information

The purpose of the information on this drawing is for:	Planning	<input checked="" type="checkbox"/>
	Information	<input type="checkbox"/>
	Comment	<input type="checkbox"/>
	Client approval	<input type="checkbox"/>
	Construction	<input type="checkbox"/>
All information on this drawing is not for construction unless it is marked for construction.	Final Issue	<input type="checkbox"/>

Client

Inland Homes

Project title

A3445 - Elmsleigh Road Staines-Upon-Thames

Drawing title

1B2P T2

Unit Plan

Scale @ A3 size

Date

1:50

Jun '20

Drawing N°

ERS-ASA-ALL-XX-DR-A-252

Revision

R4

Assael

Assael Architecture Limited
123 Upper Richmond Road
London SW15 2TL

+44 (0)20 7736 7744

info@assael.co.uk

www.assael.co.uk

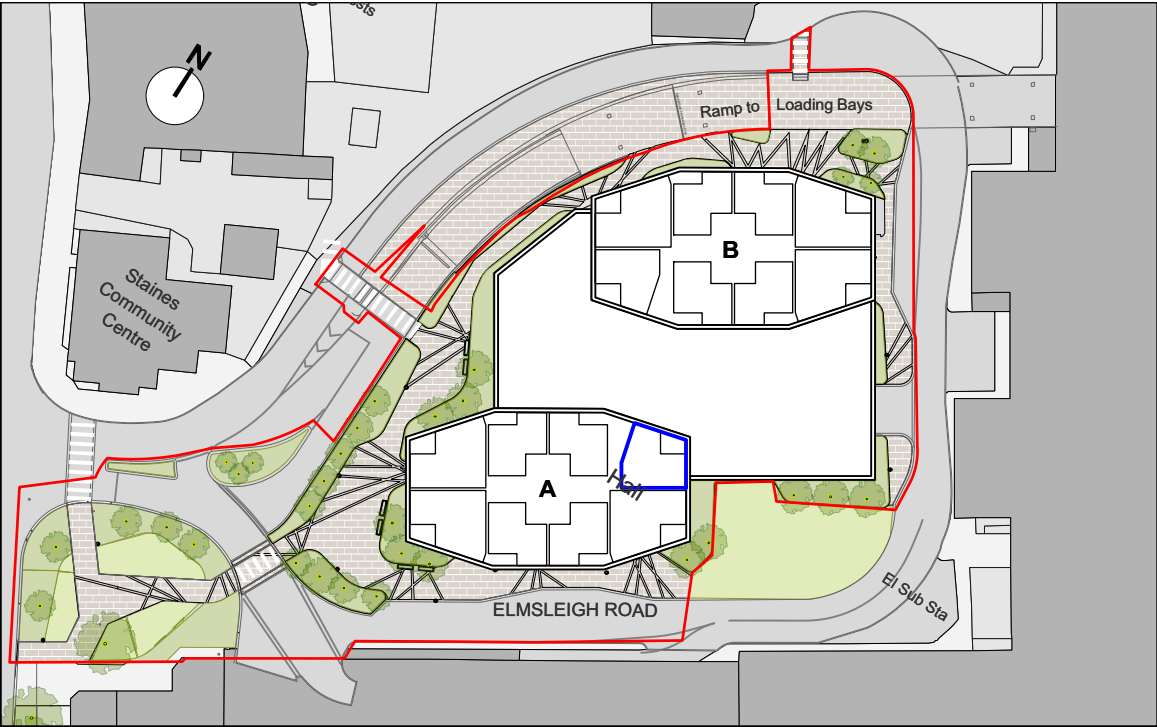

1 1B2P T2 Unit
Scale: 1:50